

PC2630 Parts List

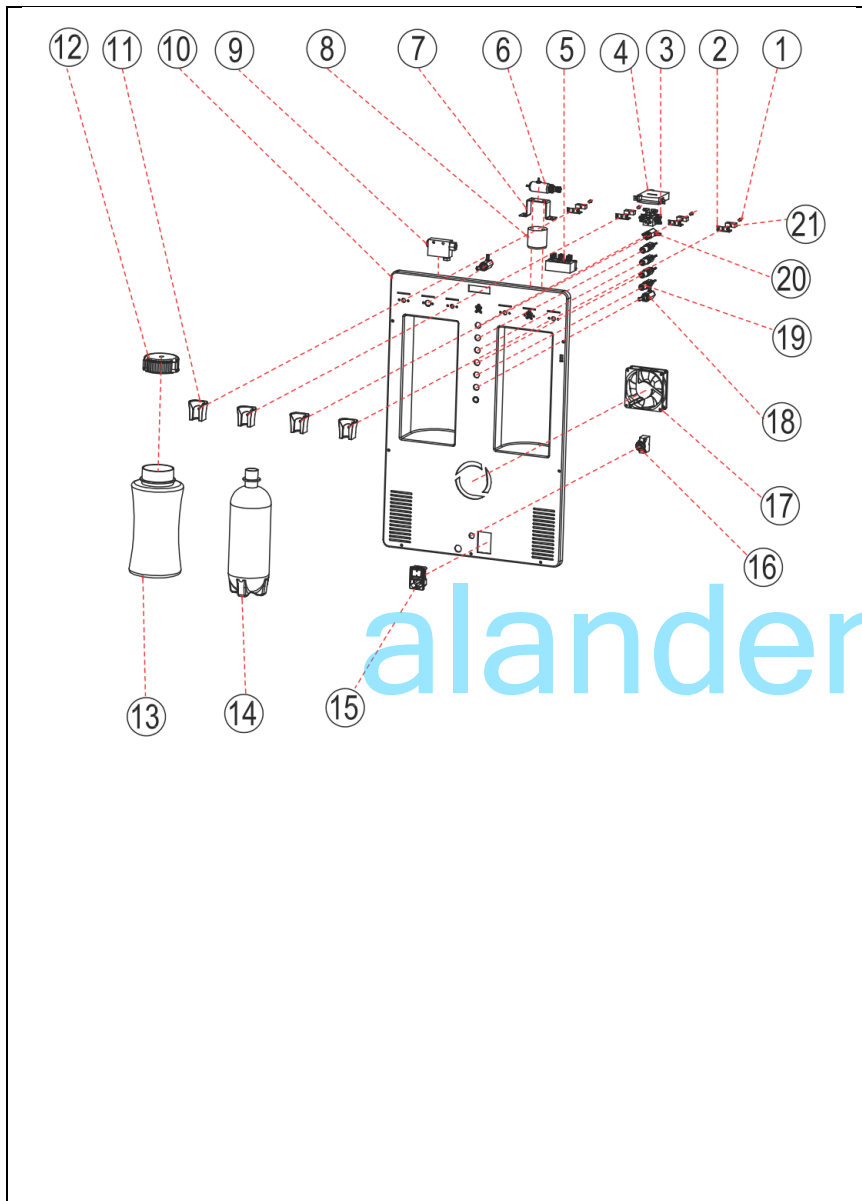

Number	Description	Part Number
1	HP Switch extension (2930) model only	PC-25-P26
2	Switch Bracket (2930) model only	PC-25-P27
3	Distribution Block	PC-P2106-M4
4	Pressure Gauge	PC-P2016
5	Water Relay	PC-P2023
6	Mini Pressure Regulator	PC-2630N-RP1
7	Bottle Cap Bracket	NA
8	Bottle Cap	PC-P2105
9	Air Venturi Valve	PC-2630-P001
10	Front Control Cover	PC-P2203
11	Handpiece Holder	PCP-N-RP1
12	Waste Bottle Cap	Included with PN 13.
13	Waste Bottle	PC-2630N-SWC
14	Clean Water Bottle 750ml	PC-P2107
15	On / Off Receptacle	PC-P2005C-N
16	Resettable Fuse	PC-P2027-10
17	Cooling Fan	PC-P2006
18	Routing Valve (PC-2630) Model only	PC-P2104
19	Flow Control Needle Valve	52007
20	ON/Off toggle (Bottle System)	52010
21	Switch (PC-2930) model only	NA
22	HP tubing 5'	52036
23	Syringe Tubing 5'	52038
24	Saliva Ejector Tubing per ft.	2000-SETUBING
25	Foot Control	53117
26	3-Way Syringe	TPC3-WAY

PC2630 Parts List

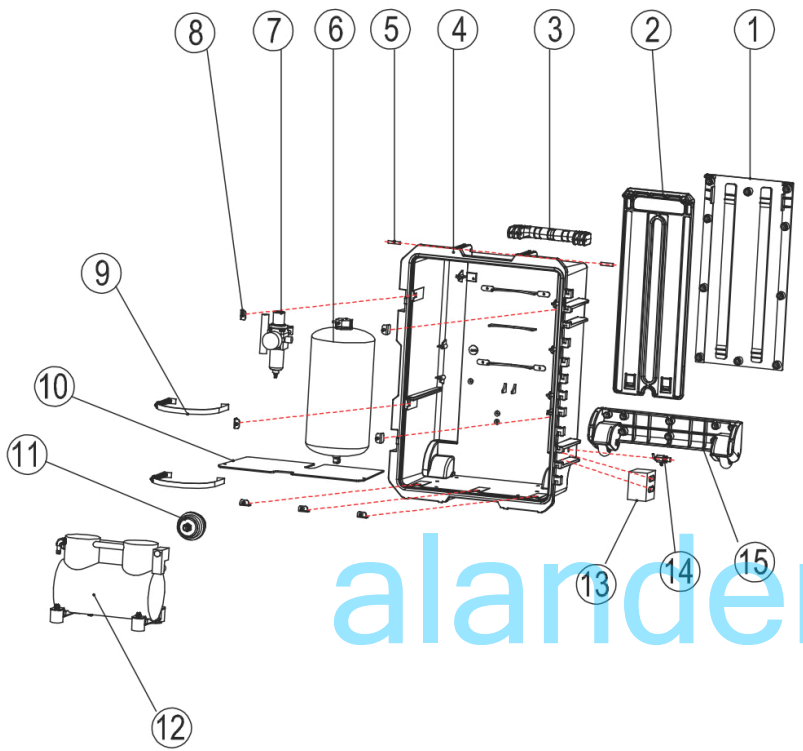

The diagram shows an exploded view of the PC2630 dental unit. The components are numbered 1 through 15. 1 is the back support plate, 2 is the pull handle, 3 is the handle, 4 is the back case, 5 is the handle pin, 6 is the tank with check valve, 7 is the master regulator with separator, 8 is the mounting bracket, 9 is the tank strap, 10 is the separator plate, 11 is the air filter, 12 is the motor with start cap, 13 is the door latch, 14 is the drain valve, and 15 is the wheel assembly. Red dashed lines indicate the assembly alignment.

Number	Description	Part Number
1	Back Support Plate	
2	Pull Handle	PC-P1004
3	Handle	PC-P2204
4	Back Case	PC-P2204-P
5	Handle Pin	
6	Tank w/ Check Valve	PC-P1003
7	Master Regulator W/ Separator	PC-P2630N-P2004
8	Mounting bracket	
9	Tank Strap	
10	Separator Plate	
11	Air Filter	PC-P2014
12	Motor W/ Start Cap 110V	PC-P1001
13	Door Latch	
14	Drain Valve	PC-P2017
15	Wheel assembly	PC-P2202

Number	Description	Part Number
1	90 Degree Elbow C	
2	90 degree elbow T	
3	Motor 110V Complete	PC-P1001
4	Threaded union	
5	Pressure Relif Valve	PC-2630N-PW
6	Capacitor > included w/ Motor	
7	Nut	
8	Washer	
9	Motor Bracket	
10	Rubber Leg	
11	Screw	
12		